

Features

Answer/End Call: Short press the MFB for 1 second to answer/end a phone call.

Redial Call: Press Volume + and Volume – for 0.5 seconds.

Answer 2nd Call: Review page 5 in the manual for various options.

Voice Assistant: Speak directly into the microphone and ask for the Voice Assistant (such as Apple Siri, Google Assistant, Samsung Bixby, etc.) or double press the MFB to activate.

Microphone Mute: During phone calls, the microphone can be muted by pressing Vol+ and Vol- for 1 second.

Turn of LED for nighttime usage: LED can be turned off by pressing Vol+ and Vol- simultaneously for 5 seconds. This function can only be activated in standby or connected mode. To turn the LED back on, press Vol+ and Vol- simultaneously for 5 seconds.

Change Prompt Language: Press the MFB and Volume+ button simultaneously for 1 second. This function can only be activated in standby or connected mode. The following languages are selectable: English, French, German, and Spanish. Each successive button press will cycle to the next language.

Volume: Short Press Vol+ or Vol- to increase/decrease volume.

Streaming Audio: Long press MFB to play/pause. Long press Vol+/Vol- to skip or select previous song.

Quick Pairing Instructions

1. From “Off State” Initiate Standard Bluetooth pairing by pressing the Multi-function Button (MFB) for 6 seconds - press and hold the button until you hear “**Pairing, please wait**” and the LED alternately flashes red and blue.
2. Use the device’s Bluetooth search and pairing functionality and select “**MC1-EcoPro**”. If necessary, enter four zeros (0000) for the passcode and accept connection.
3. For Touch-to-Pair, initiate Standard Bluetooth pairing, then touch the headset NFC tag to the NFC tag of host. The headset NFC Tag is in the Microphone Assembly.
4. Multipoint Pairing allows a single Bluetooth headset to maintain simultaneous connections to at least two source devices like a laptop and smartphone.

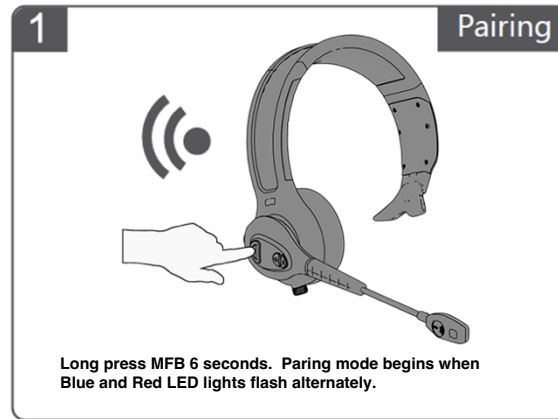

Download the App

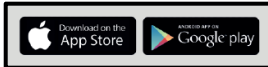

Monitor your light exposure live in the app. The charging screen on the app will let you know if your headset is receiving great charging or poor charging depending on the light exposure.

More Light. More Power

Use QR Code to download app.

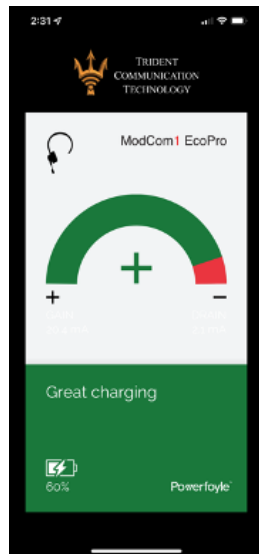

MC1-EcoPro™ Quick Start Guide

Adjust Flexband and T-Bar for Perfect Fit

Headband is adjustable in top half (highlighted).

1. Flex Highlighted Area to Widen or Tighten.
2. Adjust T-Bar.

