



TRIDENT  
COMMUNICATION  
TECHNOLOGY



# MC1-EcoPro™ User Manual



# Important Safety Tip

**Be Cautious of Excessive Volume Levels**

Volume levels are measured in decibels (dB). Exposing your ears to any noise at or above 85 dB can cause gradual hearing loss.

According to the Occupational Safety and Health Administration (OSHA), listening to volume levels over 100 dB for more than two hours at a time can lead to hearing loss.

<http://www.osha.gov/SLTC/noisehearingconservation/#loud>

# Table of Contents

THANK YOU .....	4
PLEASE READ THIS REFERENCE MANUAL.....	4
PRODUCT OVERVIEW .....	4
BASIC OPERATIONS .....	5
CONNECTING HEADSET TO A BLUETOOTH DEVICE .....	7
PAIRING .....	7
MULTIPOINT PAIRING.....	8
CHARGING THE HEADSET.....	9
USING SOLAR POWERED ENERGY .....	9
USING A MICRO-USB CHARGER .....	9
POSITIONING THE BOOM.....	10
ADJUSTING THE HEADBAND .....	11
MIC BOOM TENSION .....	12
INSTALLING WINDSCREEN AND EAR CUSHION .....	13
PATENTS.....	14
OPERATING SPECIFICATIONS .....	14
CLEANING AND MAINTENANCE .....	14
TROUBLESHOOTING .....	15
BATTERY SAFETY GUIDELINES .....	16
WARRANTY AND CUSTOMER SUPPORT .....	17
WHAT'S IN THE BOX .....	18
SAFETY AND REGULATORY INFORMATION .....	19
SPECIFICATIONS.....	21
FAQ .....	22

## THANK YOU

We appreciate your purchase of the Trident MC1-EcoPro Headset. This rugged wireless headset combines high-quality audio performance, environmental durability, and advanced Solar Cell Power technology that converts light into energy for continuous battery life.

## PLEASE READ THIS REFERENCE MANUAL

Please take the time to follow the instructions in this reference guide carefully. It will help you set up and operate your MC1-EcoPro Headset properly and enjoy its advanced features. Please save this guide for future assistance.

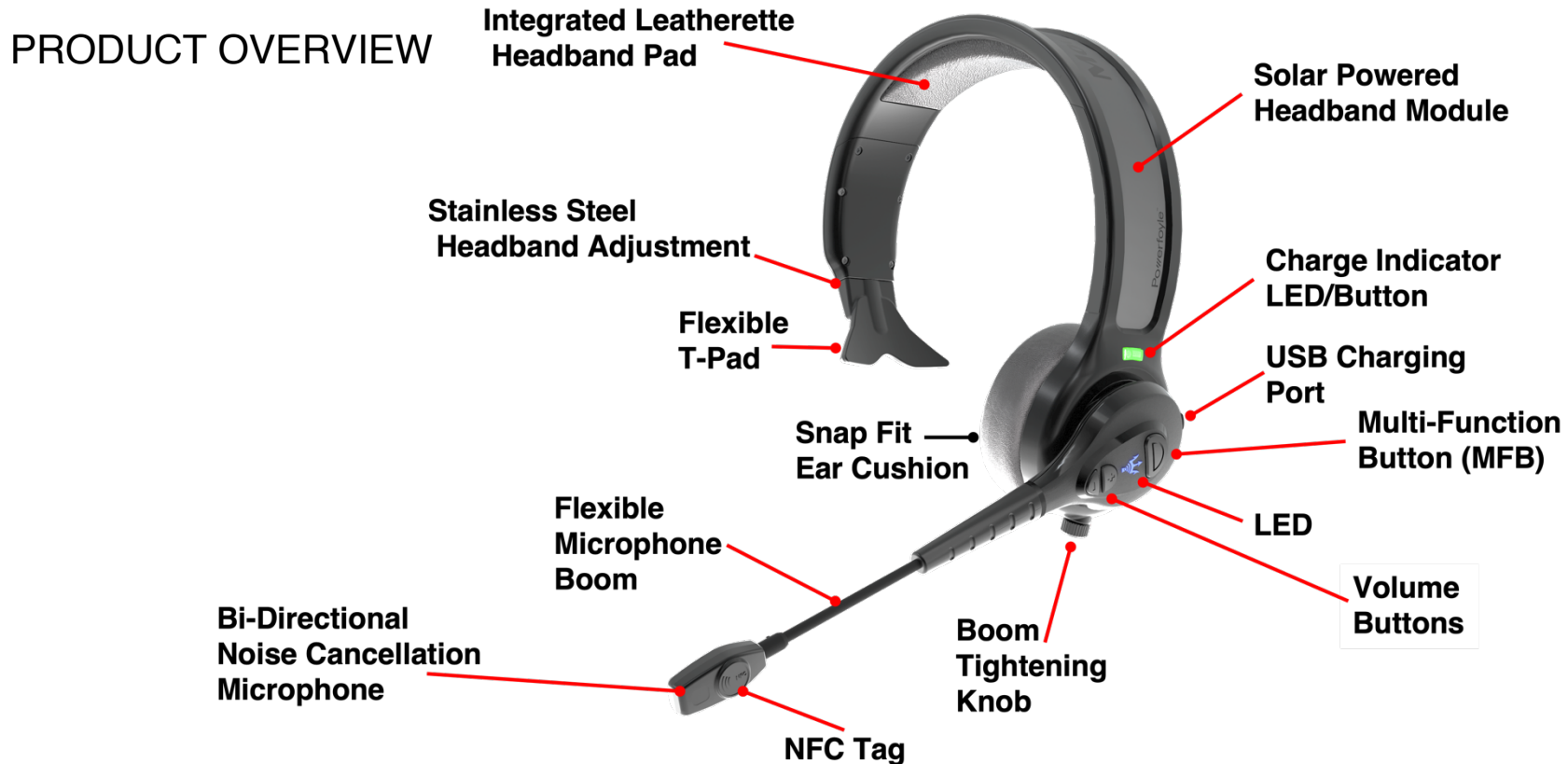

## BASIC OPERATIONS

Button	Function	Operation Instruction
Multi-Function Button (MFB)	Power On	Press the MFB (Multi-Function Button) for 6 seconds to turn on headset. You will hear a prompt " <b>ModCom One Eco-Pro Activated</b> ", and then "Pairing, please wait". Once the headset is connected to your device successfully, you will hear "Device Connected".
	Power Off	Press the MFB for 4 seconds to turn off headset. You will hear a prompt tone " <b>ModCom One Eco-Pro Off</b> ".
	Redial Last Call	Press Volume + and Volume – for 0.5 seconds
	Voice Dialing	To initiate the Bluetooth Device’s Voice Assistant (such as Apple Siri, Google Assistant, Samsung Bixby, etc.), double press the MFB. Listen for the tone, then begin speaking.
	Answer a Call	Short press the MFB for 1 second to answer a phone call.
	Hang Up a Call	Short press the MFB for 1 second to end a call.
	Answer 2nd Incoming Call	To answer a second incoming call and end the ongoing call, tap or press the MFB for 0.5 seconds.
		To answer a second incoming call and place the ongoing call (the first call) on HOLD, double press the MFB. To end the second call and resume the 1st call on HOLD, tap or press the MFB for 0.5 seconds Double tap to switch between the 1st and 2nd call
	Reject a Call	Long Press and hold the MFB for 1 second to ignore an incoming call.
Play/Pause	Long press for 1 second	
Changing Language	Press the MFB and Volume+ button simultaneously for 1 second. This function can only be activated in standby or connected mode. The following languages are selectable: English, French, German, and Spanish. Each successive button press will cycle to the next language.	
Volume +	Volume Up	Short press
	Next Song	Long press for 1 second
Volume -	Volume Down	Short press
	Previous Song	Long press for 1 second when at the start of a song. If not at the start of a song, repeat the process.

Volume + & Volume -	Mic Mute	During phone calls, the microphone can be muted by pressing Vol+ and Vol- for 1 second. User will hear a prompt "Mute On". A double tone will alert user every 10 seconds that the microphone is muted. Pressing Vol+ and Vol- for 1 second will deactivate the Microphone Mute function. User will hear a prompt "Mute Off".
	Turning BT LED light Off	The MC1-EcoPro LED can be turned off by pressing Vol+ and Vol- simultaneously for 5 seconds. This function can only be activated in standby or connected mode.
	Turning BT LED light On	To turn the LED back on, press Vol+ and Vol- simultaneously for 5 seconds.

## LED INDICATION

Mode	LED Indication
Power On	Blue LED flashes 3 times
Power Off	Red LED flashes 3 times
Pairing Mode	Red and Blue LED flashes alternately
Connected	Blue LED flashes once every 2 seconds
Disconnected	Solid Blue LED
Standby	Solid Blue LED for 4 minutes, then auto shuts off
Music Playing Mode	Blue LED flashes twice every 2 seconds
Talking Mode	Blue LED flashes once every 3 seconds
Charging	Solid Red LED (Charging while power on; Red LED will override the Blue LED)
Fully Charged	Solid Blue LED
Low Voltage	Red LED flashes twice every 2 seconds

## CONNECTING HEADSET TO A BLUETOOTH DEVICE

You can connect the Eco-Pro Headset with a Bluetooth device, such as a smartphone, This process is called “Pairing”.

### PAIRING

The headset may be paired with Bluetooth devices using one of two methods:

1. Standard Bluetooth pairing where the headset is discovered by the Bluetooth device.
2. Touch-to-Pair with devices supporting an NFC Connection (typically Android devices and not typically Apple/iPhone devices).

Headset must be within close proximity of the Bluetooth device to complete pairing. To initiate pairing, headset must be powered off. If the headset is ON, turn the headset OFF by pressing the Multi-Function Button (MFB) for 4 seconds.

1. Initiate Standard Bluetooth pairing by pressing the MFB for 6 seconds - press and hold the button until you hear “Pairing, please wait” and the LED alternately flashes red and blue. Use the device’s Bluetooth search and pairing functionality (refer to the Device or Host documentation if necessary) and select “**MC1-EcoPro**”. If necessary, enter four zeros (0000) for the passcode and accept connection.

2. For Touch-to-Pair, (on Android devices or other devices supporting an NFC Connection), initiate Standard Bluetooth pairing, then touch the headset NFC tag to the NFC tag of host. The headset NFC Tag is located in the Microphone Assembly.

Once successfully paired, you will hear “Device Connected” and the LED will flash blue, once every two seconds indicating the headset and Bluetooth device are connected. The headset may be paired to a new Bluetooth device using the above procedure. Note that this will undo the pairing to the current Bluetooth device. Once the headset and Bluetooth device have been paired, the headset and Bluetooth device will automatically reconnect the next time they are both powered on and in close proximity to each other.

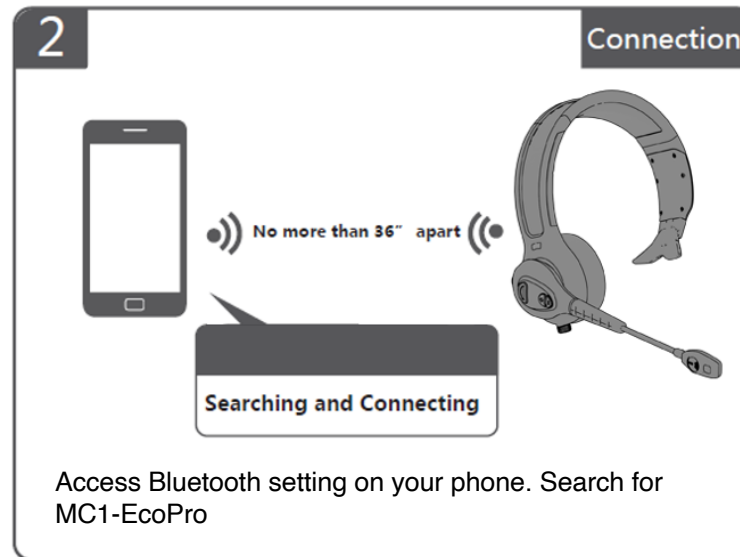
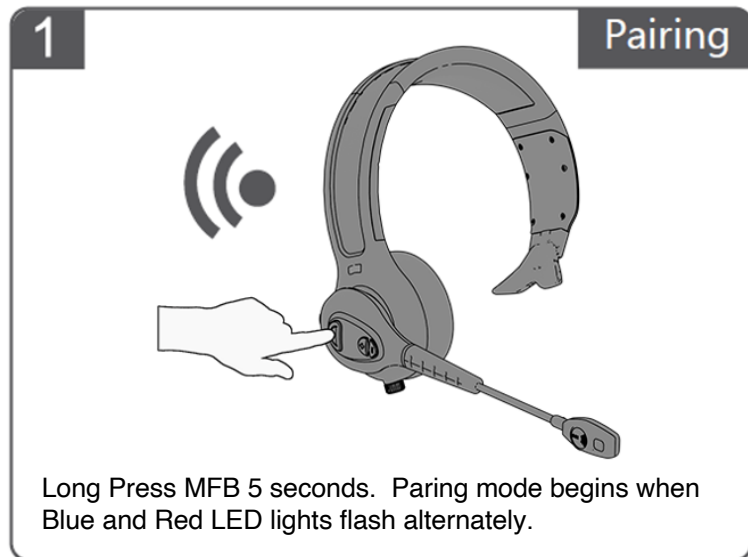

## MULTIPOINT PAIRING

It may be useful to have the headset connected to 2 devices simultaneously. It is a feature that allows a single Bluetooth headset to maintain simultaneous connections to at least two source devices like a laptop and smartphone. This is called Multipoint pairing.

For Multipoint pairing:

1. Turn off Bluetooth on the 1st connected device.
2. Turn on Bluetooth on the second device.
3. Initiate Pairing on the headset (refer to Pairing section).
4. Pair the headset with the second device. You should hear an alert, "Device Connected".
5. Turn ON Bluetooth on the 1st device. Using the Device Bluetooth search menu, reconnect to the MC1-EcoPro Headset. You should hear a second "Device Connected" alert.

Your headset is now connected with both devices and can now accept a call or listen to audio/video from either device.



# CHARGING THE HEADSET

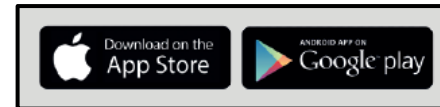

## USING SOLAR-POWERED ENERGY

1. Download the app: Trident MC1-EcoPro
2. Monitor your light exposure live in the app. The charging screen on the app will let you know if your headset is receiving great charging or poor charging depending on the light exposure.
3. The gain/charge of the headset will increase as the exposure to sunlight increases.
4. A hook is provided as a way of mounting the headset for optimal light exposure when the headset is not in use.



More Light. More Power:



## USING A MICRO-USB CHARGER

During low light situations, there is a USB port that can be used with an optional USB wall charger and cable.

1. Remove the USB Charging Port Cover and connect Charging Cable to a USB adapter.
2. Insert the Charging Cable into the headset USB Port.
3. Charge for 3 hours prior to use.

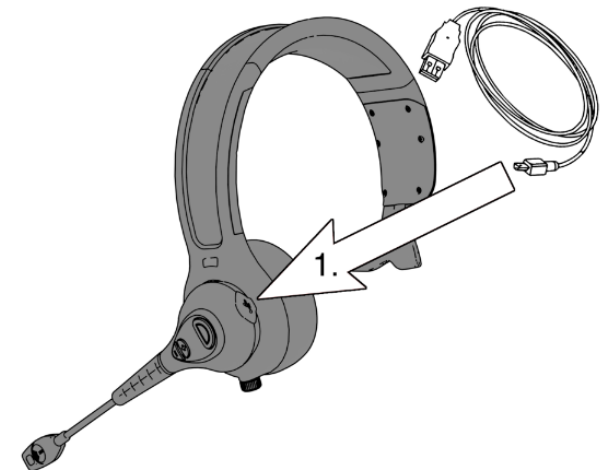

Solid Red LED indicates charging.  
Solid Blue LED indicates headset is fully charged.

## POSITIONING THE BOOM

Do not rotate the boom beyond the stop point.

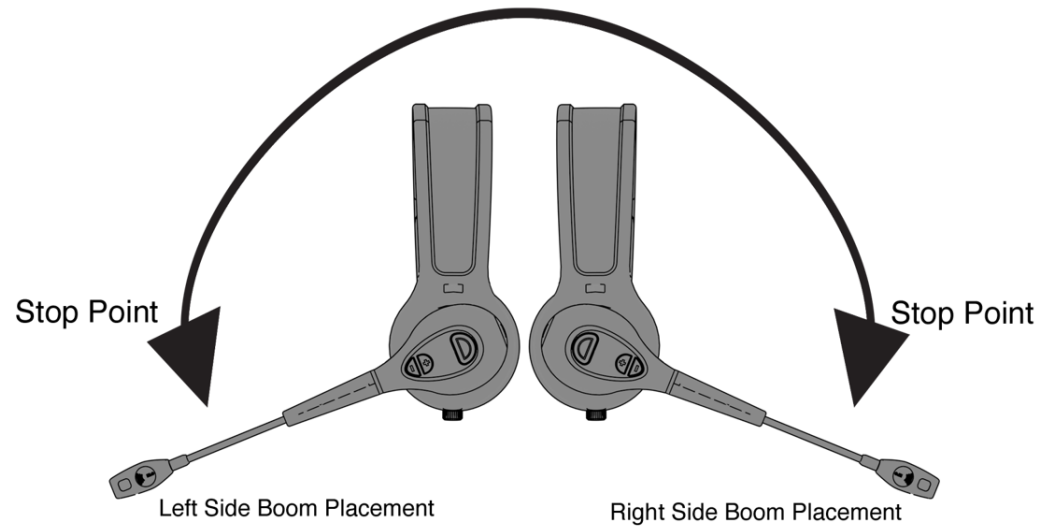

## ADJUSTING THE HEADBAND

The fully-adjustable Stainless-steel Headband Adjustment will click as it is lengthened or shortened to size for a comfortable fit.

The headband can also be squeezed or stretched carefully to adjust the fit:

1. To loosen the headband fit, flex the center portion of the headband outward.
2. For a tighter headband fit, bend the center portion of the headband inward to create a tighter radius with additional clamping force to the head.

When adjusting the headband:

- Position the ear cushion in the center of the ear.
- Position the T-Pad above the ear, halfway between the top of the ear and the top of the head.

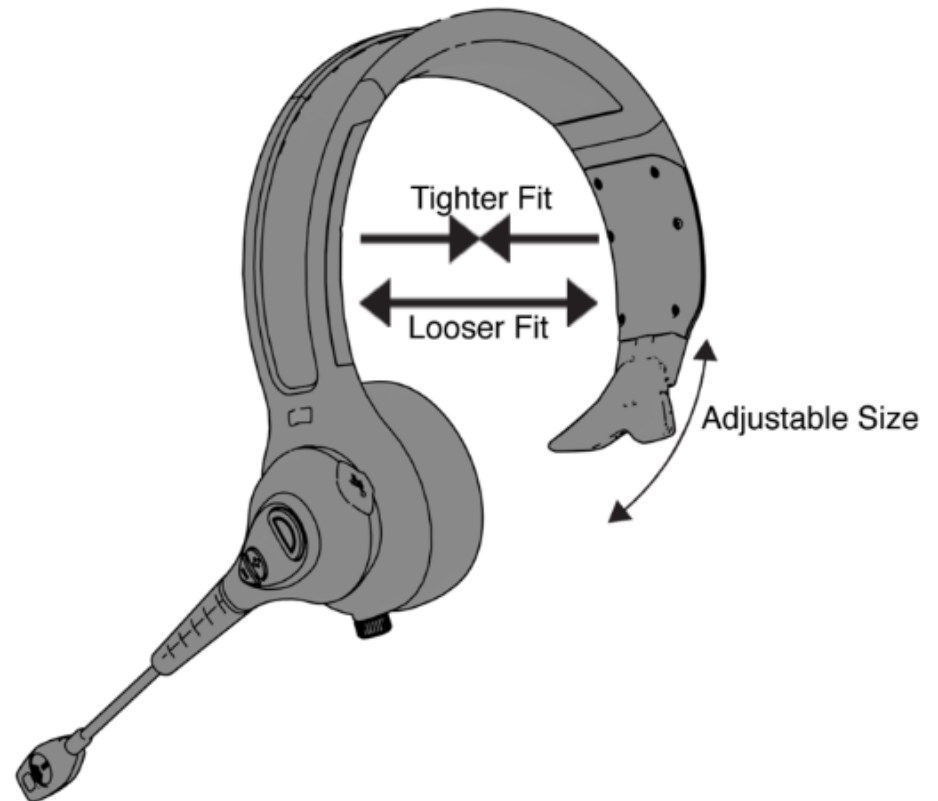

## MIC BOOM TENSION

The microphone boom position tension can be adjusted. Simply tighten or loosen the mic boom by tightening or loosening the Boom Tightening Knob (Set Screw) as shown.

1. Loosen the Headband Set Screw (counterclockwise) or tighten (clockwise) to loosen or tighten the boom position up or down. It is not necessary to disassemble your MC1-EcoPro Headset. However, if the headband were to become separated from the mic boom, simply reattach it as shown and tighten the Set Screw. This feature allows for future accessories.
2. Reattach the Bluetooth Headset Module (mic boom) to headband and tighten the Set Screw.

**IMPORTANT NOTICE:** Do not remove the MC1-EcoPro Headband from the module. In the event that the solar headband is removed, the Headset must be turned OFF. If solar panel is removed when the headset is ON, it will require plugging it in to a USB Charger to power back on.



## INSTALLING THE WINDSCREEN AND EAR CUSHION

The microphone Windscreen and the speaker Ear Cushion are both easily replaceable.

1. Slide the mic Windscreen over the microphone assembly like a sock.
2. The Ear Cushion snaps on to the headband assembly. Unsnap the cushion from the headband to replace or interchange.

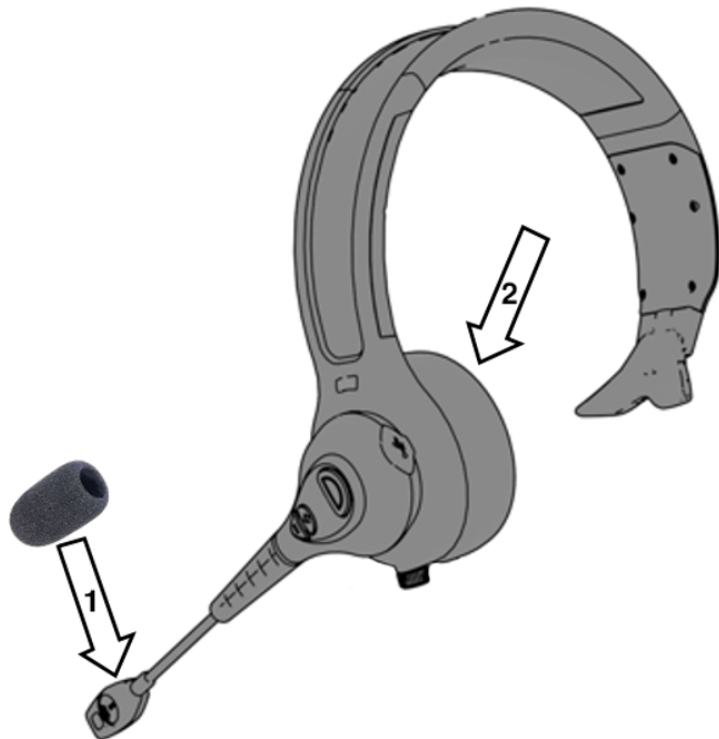

### MICROPHONE ORIENTATION

#### Talk Side

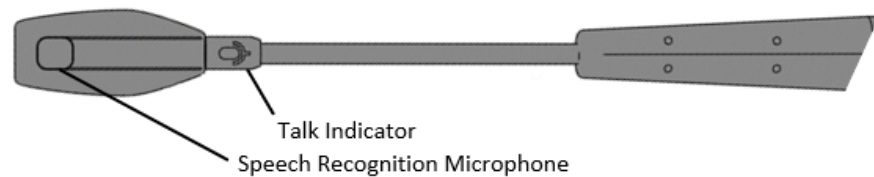

#### Noise Cancellation Side

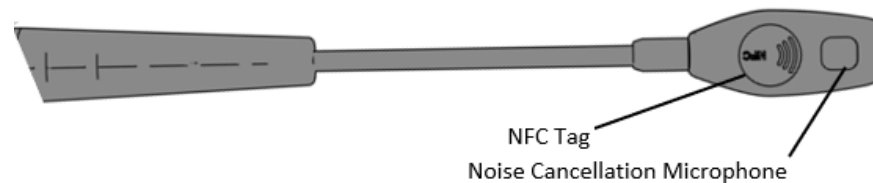

## PATENTS

US Patent: 9,813,799, D760,689, D76090, D755,122, and D749,042, other patents pending.



The Bluetooth® word mark and logos are registered trademarks owned by Bluetooth SIG, Inc. and any use of such marks by Trident Communication Technology is under license. Other trademarks and trade names are those of their respective owners.

## OPERATING SPECIFICATIONS

The MC1-EcoPro Bluetooth headset operates in the Bluetooth Band of 2.402 ~ 2.480 GHz with an RF Output Power max BT:5.51dBm/BLE:1.31dBm (For CE)

## CLEANING AND MAINTENANCE

To maintain your MC1-EcoPro Bluetooth headset we suggest the following guidelines:

- Do not expose the headset to harsh chemicals or cleaning agents.
- If the headset becomes dirty, wipe it with a soft damp cloth. Do not use soap, cleaning fluids or chemicals.
- Keep dust, water, dirt, and debris out of the USB Charger Slot.

# TROUBLESHOOTING

Operation	Problem	Possible Solution
Operating	Headset will not turn on	<p>Make sure headset is fully charged.</p> <p>Make sure headset is charged by exposing the headset to light or by placing a USB Cable in the USB Charging Slot and follow the headset charging instructions.</p>
	Headset turned off	If the headset is in standby mode, it will shut off on its own after 10 minutes to preserve energy. Once turned off, the headset will not drain.
Pairing	Does Not Pair	Headset should be OFF when beginning the pairing process.
		Make sure intended Bluetooth device is turned on.
		Make sure the headset is within 12 inches of intended Bluetooth device.
	Make sure you select "MC1-EcoPro" on the Bluetooth device's Bluetooth search menu.	
Headset appears to be connected but cannot communicate with the intended Bluetooth Device	<p>Headset may be connected with a different Bluetooth device.</p> <ol style="list-style-type: none"> <li>1. Make sure the intended Bluetooth device is within 12 inches of headset.</li> <li>2. Make sure all other non-intended Bluetooth devices are at least 10 feet away from the headset.</li> <li>3. Turn off the headset and start the pairing process again</li> </ol>	
LED	No LED light visible on Headset.	Press Vol+ AND Vol- simultaneously for 5 seconds to turn LED ON. Pressing Vol+ and Vol- again, simultaneously for 5 seconds, will turn the LED OFF. The LED on/off will not function while streaming audio or while a call is in progress. This function can only be activated in standby or connected mode.
NFC	NFC Does not Pair	For Touch-to-Pair, (on Android devices or other devices supporting an NFC Connection), initiate Standard Bluetooth Pairing <b>before</b> touching the Headset NFC tag to the NFC tag of the Bluetooth Device. The headset NFC Tag is located in Microphone Assembly.

## BATTERY SAFETY GUIDELINES

- The area in which the headset is charged should be clear of debris and combustible materials or chemicals. Improper charging use may result in a fire, explosion, or other hazard.
- To charge the headset battery, the headset and USB charger temperatures must be between 41°-95°F (5°C-35°C).
- Do not use incompatible batteries and/or chargers. Use of an incompatible USB charger may present a risk of fire, explosion, leakage, or another hazard. If you have any questions about the compatibility of a USB charger, contact your Distributor Customer Support.
- Do not disassemble, open, crush, bend, deform, puncture, or shred the headset.
- Severe impact from dropping any battery-operated device on a hard surface could cause the battery to overheat.
- Do not short circuit the headset or allow metallic or conductive objects to contact the USB Charging Slot.
- Do not modify or remanufacture, attempt to insert foreign objects into the USB Charging Slot, immerse or expose to water or other liquids, or expose to fire, explosion, or another hazard.
- Do not place headset in a microwave oven, conventional oven, toaster oven, washer, dryer, dishwasher, or other mechanical devices.
- Headset usage by children should be supervised.
- Follow local regulations to properly dispose of a used headset.
- Do not dispose of headset in fire.
- Seek medical advice immediately if a battery has been swallowed.
- In the event of a battery leak, do not allow the liquid to come in contact with the skin or eyes. If contact is made, wash the affected area with large amounts of water and seek medical advice.
- If you suspect damage to your headset, contact Trident Communication Technology Customer Support to arrange for inspection.



## WARRANTY AND CUSTOMER SUPPORT

- For the complete Trident Communication Technology, LLC. hardware product warranty statement, visit: <http://www.tridentcomtech.com/warranty>
- If you have problem using your equipment in North America, contact Trident Customer Support at [customer.support@tridentcomtech.com](mailto:customer.support@tridentcomtech.com)  
Trident Communication Technology  
8 Faulkner Hill Road, Acton, MA 01720 USA
- If you have problem using your equipment in Europe, contact D3 Technical Support at [customer.support@tridentcomtech.com](mailto:customer.support@tridentcomtech.com)  
D3 Technical Partners, LLC.  
Ruysdaelplein 3  
Naarden 1411RD Noord Holland Netherlands
- For the latest version of this User Manual visit: <http://www.tridentcomtech.com/manuals>

## WHAT'S IN THE BOX

1. Headset
2. Quick Start Guide
3. Hook Headset Hanger



The Headset and Hook are packaged in an earth- friendly inner tray. The inner tray is made up of recyclable material which helps reduce a carbon footprint and aids in preserving natural resources.

# SAFETY AND REGULATORY INFORMATION



- Warnings for use of Wireless Devices. Please observe all warning notices regarding the usage of wireless devices.



- Potentially Hazardous Atmospheres– Vehicles Use. You are reminded of the need to observe restrictions on the use of radio devices in fuel depots, chemical plants etc. and areas where the air contains chemicals or particles (such as grain, dust, or metal powders) and any other area where you would normally be advised to turn off your vehicle engine.



- Potentially Hazardous Atmospheres – Fixed Installations. You are reminded of the need to observe restrictions on the use of radio devices in fuel depots, chemical plants etc. and areas where the air contains chemicals or particles (such as grain, dust, or metal powders).
- Contains small parts which can be a choking hazard.

- Not suitable for children under age 3.

- This product contains magnets which can be harmful to pacemakers, or similar medical devices.

- To reduce the risk of fire or electrical shock, do not expose the product to rain or moisture.

- As with any electronic products, use care not to spill liquids into any part of the system. Liquids can cause a failure and/or a fire hazard.

- Do not place any naked flame sources, such as lighted candles, on or near the apparatus.

- Use caution when using your headset while operating a vehicle or engaging in any activity that requires your full attention. Check and follow local laws regarding mobile phone and headset use. Some jurisdictions impose specific limitations, such as single earpiece configuration, on the use of such products while driving.

- Sounds that you rely on as reminders or warnings may sound different when using a headset. Be aware of how these sounds may vary in character so you can recognize them as needed.

- Do not leave a battery on prolonged charge when not in use.



## CAUTION

- Do not make modifications to the headset or accessories. Unauthorized alterations may compromise safety, regulatory compliance, and product performance and warranty.



## Prevention of Hearing Loss

- To prevent possible hearing damage, do not listen at high volume levels for long periods.
- Use only with the supplied power supply meeting local regulatory requirements (ex. UL, CSA, VDE, CCC).
- Use caution when using a Headset while operating a motor vehicle or anywhere the inability to hear outside sounds may present a danger to you or others.
- The EcoPro Headset does not require scheduled cleaning. Should cleaning be necessary, simply wipe the outside surfaces with a soft damp cloth

## Regulatory Information

All Trident Communication Technology devices are designed to be compliant with rules and regulations in the locations they are sold and will be labeled as required. This regulatory information applies to MC1-EcoPro.

## International

This device complies with internationally recognized standards covering human exposure to electromagnetic fields from radio devices

## Wireless Device Country Approvals

Regulatory markings, subject to certification, are applied to the device signifying the radio (s) is/are approved for use in the following countries: United States, Canada, and Europe.

**Note:** Europe includes Austria, Belgium, Bulgaria, Czech Republic, Cyprus, Denmark, Estonia, Finland, France, Germany, Greece, Hungary, Iceland, Ireland, Italy, Latvia, Liechtenstein, Lithuania, Luxembourg, Malta, Netherlands, Norway, Poland, Portugal, Romania, Slovak Republic, Slovenia, Spain, Sweden, Switzerland and the United Kingdom.

**CE NOTICE TO USERS**

Trident Communication Technology hereby declares that this product in in compliance with the essential requirements and other relevant provisions EU RED - DIRECTIVE 2014/53/EU-LOW VOLTAGE DIRECTIVE 2014/35/EU and all other applicable EU directive requirements.

**FCC/IC NOTICE TO USERS**

The device has been evaluated to meet general RF exposure requirement. The device can be used in portable exposure condition without restriction.

This device complies with part 15 of the FCC Rules. Operation is subject to the following two conditions:

- 1) This device may not cause harmful interference, and
- 2) This device must accept any interference received, including interference that may cause undesired operation.

**In the United States:**

This equipment has been tested and found to comply with the limits for a Class B digital device, pursuant to Part 15 of the FCC Rules. These limits are designed to provide reasonable protection against harmful interference in a residential installation. This equipment generates, uses, and can radiate radio frequency energy and, if not installed and used in accordance with the instructions, may cause harmful interference to radio communications.

However, this is no guarantee that interference will not occur in a particular installation. If this equipment does cause harmful interference to radio or television reception, which can be determined by turning the equipment off and on, you are encouraged to try to correct the interference by one or more of the following measures:

- Reorient or relocate the receiving antenna.
- Increase the separation between the equipment and receiver.
- Connect the Headset Charger to an outlet on a different circuit than the one to which the receiver is connected.
- Consult the dealer or an experienced radio/TV technician for help.

Changes or modifications not expressly approved by Trident Communication Technology will void the user's authority to operate this equipment

**In Canada:**

This device complies with License-exempt transmitter(s)/receiver(s) that comply with Innovation, Science and Economic Development Canada is license-exempt RSS9s). Operation is subject to the following two conditions:

- 1) This device may not cause harmful interference, and
- 2) This device must accept any interference received, including interference that may cause undesired operation.

L'appareil a été évalué pour répondre aux exigences générales en matière 'exposition aux radiofréquences. L'appareil peut être utilisé dans des conditions depositions portables sans restriction. Cet appareil contient des émetteurs / récepteurs exemptés de licence conformes aux RSS (RSS) d'Innovation, Sciences et Développement économique Canada, L'exploitation est autorisée aux deux conditions suivantes:  
 1. l'appareil ne doit pas produire de brouillage, et  
 2. l'utilisateur de l'appareil doit accepter tout brouillage radioélectrique subi, même si le brouillage est susceptible d'en compromettre le fonctionnement. This class B digital apparatus complies with CAN ICES-3 (B) / NMB-3 (B)

**Waste Electrical and Electronic Equipment**

This symbol on the product or on its packaging indicates that this product must not be disposed of with your other household waste. Instead, it is your responsibility to dispose of your waste equipment by handing it over to a designated collection point for the recycling of waste electrical and electronic equipment. The separate collection and recycling of your waste equipment at the time of disposal will help to conserve natural resources and ensure that it is recycled in a manner that protects human health and the environment.



## SPECIFICATIONS

Bluetooth Specification	Bluetooth 5.0
CODEC	AAC, SBC
Bluetooth Profile	HFPV1.6, HSPV1.2, A2DPV1.2, AVRCPV1.0, PBAP, SPP, OPP, GOEP, FTP, HID
Operation Range	Up to 100 ft
Talk Time	36 hours
Standby Time	300 hours
Charging Time	2 hours with USB. Solar - TBD
Battery Type	3.7V, 400mAh, Lithium polymer battery
Overall Dimension	180mm x 200mm x 70mm
Net Weight	6.3 oz
Operating Temp	-20°C to 50°C   -4°F to 122°F

## FAQ

### **Q: What is Powerfoyle?**

A: Powerfoyle is a groundbreaking innovation within solar cell technology.

### **Q: How does Powerfoyle work?**

A: It is a solar cell material that harvests all forms of light, indoor and outdoor, and convert it into clean, endless energy. This to give devices extended or even eternal battery lifetime.

### **Q: What light conditions charge the system?**

A: You need to rethink charging all together. All the different types of light around us will constantly charge the headset to ensure the product is charged whenever it's needed. It will give a seamless and effortless experience. Powerfoyle harvests all surrounding lights. How much it charges depends on the light conditions but simply put - the brighter the better.

### **Q: Since I (as a truck driver) spend most of the time inside my truck, how do I ensure I keep the headset charged?**

A: Included in the packaging of the MC1-EcoPro headset, Mounting Hook, Headset hanger. It's formed to fit the MC1-EcoPro headset on one end and on the other, the hanger is flexible in design and can be conformed to hang virtually anywhere that helps expose the headset to light while not in use.

### **Q: If it is always charging, how should I store the headset?**

A: When not wearing the headset, simply store close to a window or in a well-lit room. Powerfoyle is almost always charging and will charge from any light source both indoors and outdoors.

For optimum performance, we recommend that the headset is exposed to window or outdoor light daily.

### **Q: What does 'well-lit room' mean when saying that the battery can be charged indoors? Just a lamp?**

A: The Powerfoyle material can be charged by artificial light or sunlight. The stronger light, the faster charging.

### **Q: Can the Powerfoyle material accumulate dirt? If so, how can I clean it?**

A: The Powerfoyle material is durable, but as all materials, it can get dirty depending on usage. Use a soft cloth and water if you would like to clean it.

**Q: What happens if I accidentally scratch Powerfoyle or it starts peeling off?**

A: Powerfoyle is a very durable material and integrated in the headset so it cannot be peeled off. A minor scratch will not affect the performance.

**Q: Can I bend the headset?**

A: Even though the Powerfoyle solar cell is flexible, you need to be cautious as with all devices that includes electronics components.

**Q: If the Powerfoyle breaks will I still be able to use the headsets?**

A: Yes, it is still possible to charge the headset manually. However, there is no normal user scenario that we see that it will break.

**Q: Does the Powerfoyle temperature change or vary? Can it burn a bit at some point?**

A: As for all products, whatever category, the temperature of the material is depending on the temperature of the surroundings. For example, a sunny and warm day the headset will feel a bit warmer. The Powerfoyle material is durable and made to enhance products in our daily life. It will not burn unless put in fire.

**Q: Is there any heating element that might cause discomfort for the user when charging?**

A: No.

**Q: If I use a charger and place the device under the sun, will it charge faster?**

A: If you use USB-charger and place the device in the sun the charging from the USB will add power on top of Powerfoyle.

**Q: How do I know the amount of battery that I have left?**

A: Trident Communication Technology MC1-EcoPro will include an app that allows the user to monitor the headset's battery gain and drain meter live, according to light exposure and active usage as well as a battery level by percent.

**Q: How do I know how much I have charged?**

A: It will show in the app, as well as your gain and drain, so it's a good idea to check in to the app on a daily basis.



# TRIDENT COMMUNICATION TECHNOLOGY